

## Service Trolleys

### Plate Dispenser Trolley, 2 cylinders

- Ø180-300 mm

ITEM # \_\_\_\_\_

MODEL # \_\_\_\_\_

NAME # \_\_\_\_\_

SIS # \_\_\_\_\_

AIA # \_\_\_\_\_



341185 (F33NA)

Plate Dispenser Trolley,  
double cylinder, plate  
diameter 180-300 mm

### Short Form Specification

Item No. \_\_\_\_\_

Neutral plate lowerator suitable to, transport and distribute plates. Two cylinders plate lowerator: each cylinder can accommodate up to 50 plates of 300 mm diameter. Guiding profiles inside the cartridges allows to accommodate different shaped plates/bowls. Constructed entirely in 304 AISI stainless steel. Unit has 4 swivel castors, two with brakes.

### Main Features

- Two cylinders plate lowerator: each cylinder can accommodate up to 50 plates of 300 mm diameter
- CB and CE certified by a third party notified body.
- Guiding profiles inside the cartridges allows to accommodate different shaped plates/bowls.
- Sprung cylinders allow plates of different weights to be stacked.
- Neutral plate lowerator suitable to transport and distribute plates.

### Construction

- Constructed entirely in 304 AISI stainless steel.
- Unit has 4 swivel castors, 2 with brakes.
- Unit has a handle to easily move the trolley.
- Bumpers on corners.

APPROVAL: \_\_\_\_\_

Front

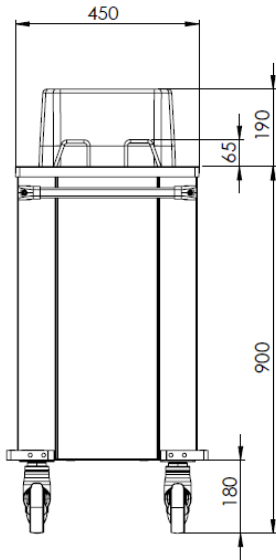

Side

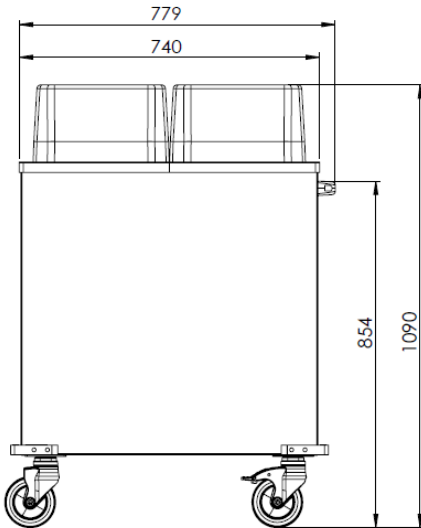

Top

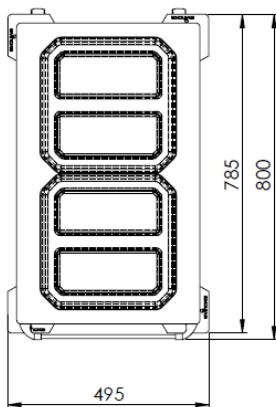

**Key Information:**

External dimensions, Width:	
341185 (F33NA)	820 mm
External dimensions, Depth:	495 mm
External dimensions, Height:	1090 mm
Wheel material:	
Wheel diameter:	
Net weight:	36 kg